

GENERAC

The Reliable Ones

3200PSI

Pressure Washer Owner's Manual

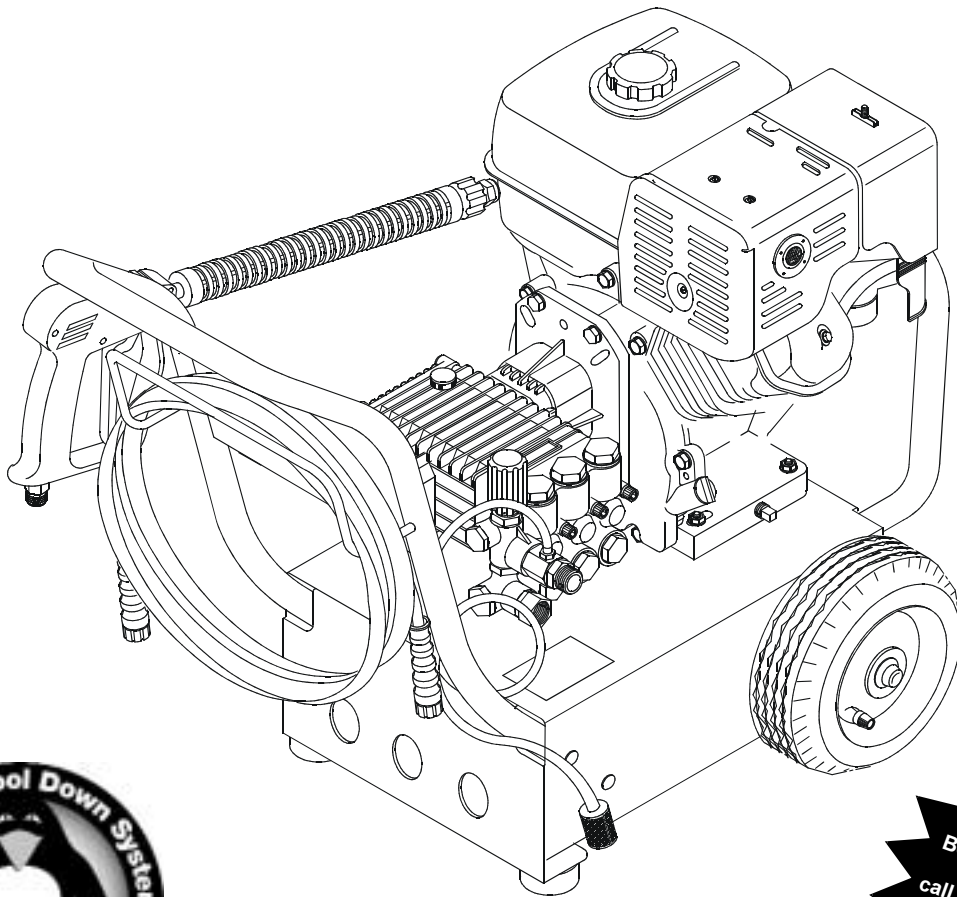

Model No. 1295-0 (3200 psi High Pressure Washer) Manual No. B3862 Revision 2 (4/28/1999)



This symbol points out important safety instructions, which, if not followed, could endanger the personal safety and/or property of yourself and others. Read and follow all instructions in the manual before attempting to operate this unit.



IMPORTANT! — SAFETY RULES — IMPORTANT!



WARNING:



The engine exhaust from this product contains chemicals known to the State of California to cause cancer, birth defects, or other reproductive harm.



CAUTION! Always disconnect spark plug wire and place wire where it cannot contact spark plug to prevent accidental starting when setting up, transporting, adjusting or making repairs to your high pressure washer.

- Engine exhaust gases contain DEADLY carbon monoxide gas. This dangerous gas, if breathed in sufficient concentrations, can cause unconsciousness or even death. Operate this equipment only in the open air where adequate ventilation is available.
- Gasoline is highly FLAMMABLE and its vapors are EXPLOSIVE. Do not permit smoking, open flames, sparks or heat in the vicinity while handling gasoline. Avoid spilling gasoline on a hot engine. Allow unit to cool for 2 minutes before refueling. Comply with all laws regulating storage and handling of gasoline.
- Locate this pressure washer in areas away from combustible materials, combustible fumes or dust.
- The high pressure equipment is designed to be used with Generac authorized parts only. If you use this equipment with parts that do not comply with minimum specifications, the user assumes all risks and liabilities.
- Some chemicals or detergents may be harmful if inhaled or ingested, causing severe nausea, fainting or poisoning. The harmful elements may cause property damage or severe injury.
- Do not allow CHILDREN to operate the Pressure Washer at any time.
- Operate engine only at governed speed. Running the engine at excessive speeds increases the hazard of personal injury. Do not tamper with parts which may increase or decrease the governed speed.
- Do not wear loose clothing, jewelry or anything that may be caught in the starter or other rotating parts.
- Before starting the Pressure Washer in cold weather, check all parts of the equipment and be sure ice has not formed there.
- Units with broken or missing parts, or without protective housing or covers should NEVER be operated.
- The muffler and air cleaner must be installed and in good condition before operating the Pressure Washer. These components act as spark arrestors if the engine backfires.
- Check the fuel system for leaks or signs of deterioration such as chafed or spongy hose, loose or missing clamps or damaged tank or cap. Correct all defects before operating the Pressure Washer.
- Do not spray flammable liquids.
- Never aim the gun at people, animals or plants.

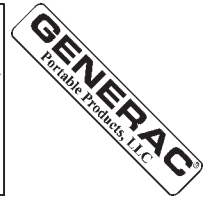

IMPORTANT! — SAFETY RULES — IMPORTANT!

- High pressure spray can cause paint chips or other particles to become airborne and fly at high speeds.
- Never allow any part of the body to come in contact with the fluid stream. DO NOT come in contact with a fluid stream created by a leak in the high pressure hose.
- The high pressure stream of water that this equipment produces can pierce skin and its underlying tissues, leading to serious injury and possible amputation.
- Always wear eye protection when you use this equipment or when you are in the vicinity where the equipment is in use.
- Operate the pressure at no more than the PSI fluid pressure rated for your pressure washer.
- Never move the machine by pulling on the high pressure hose. Use the handle provided on the top of the unit.
- Always be certain the spray gun, nozzles and accessories are correctly attached.
- Never use a spray gun which does not have a trigger lock or trigger guard in place and in working order.
- Use a respirator or mask whenever there is a chance that vapors may be inhaled. Read all instructions with mask so you are certain the mask will provide the necessary protection against inhaling harmful vapors.
- High pressure spray may damage fragile items including glass. Do not point spray gun at glass when in the jet spray mode.
- Keep the hose connected to machine or the spray gun while the system is pressurized. Disconnecting the hose while the unit is pressurized is dangerous.
- Hold the spray gun firmly in your hand before you start the unit. Failure to do so could result in an injury from a whipping spray gun. Do not leave the spray gun unattended while the machine is running.
- The cleaning area should have adequate slopes and drainage to reduce the possibility of a fall due to slippery surfaces.
- Keep water spray away from electric wiring or fatal electric shock may result.
- Do not secure trigger gun in the pull-back (open) position.
- Do not by-pass any safety device on this machine.
- The muffler and engine heat up during operation and remain hot immediately after shutting it down. Avoid contact with a hot muffler or engine or you could be severely burned.
- Operate and store this unit on a stable surface.
- High pressure hose can develop leaks from wear, kinking, abuse, etc. Water spraying from a leak is capable of injecting material into skin. Inspect hose each time before using it. Check all hoses for cuts, leaks, abrasions or bulging of cover, or damage or movement of couplings. If any of these conditions exist, replace hose immediately. Never repair high pressure hose. Replace it with another hose that meets minimum pressure rating of your pressure washer.



CONGRATULATIONS on your purchase of a GENERAC high pressure washer. It has been designed, engineered and manufactured to give you the best possible dependability and performance.

Should you experience any problem you cannot easily remedy, call the pressure washer helpline at 1-800-270-1408.

Please read and retain this manual. The instructions will enable you to assemble and maintain your high pressure washer properly.

CUSTOMER RESPONSIBILITIES

- Read and observe the safety rules.
- Follow regular schedule in maintaining, caring for and using your high pressure washer.
- Follow the instructions under “Customer Responsibilities” and “Storage” sections of this Owner's Manual.

Model Number	1295-0
Serial Number	_____
Date of Purchase	_____

The model and serial numbers will be found on a decal attached to the pressure washer. Record both serial number and date of purchase and keep in a safe place for future reference.

PRODUCT SPECIFICATIONS

Pressure Washer Specifications

- Outlet Pressure** 3200 psi
- Flow Rate** 4.0 gallons per minute (gpm)
- Detergent** Use detergent approved for pressure washers
- Water Supply** Not to Exceed 140°F
- Temperature**
- Automatic Cool Down System** Will cycle when water reaches 140°-145°F

Engine Specifications

- Engine Model** Honda
- Rated Horsepower** . . 11 HP
- Displacement** 337cc (20.6 cu. in.)
- Spark Plug**
 - Type** BPR6ES (NGK)
 - Set Gap To:** . . 028-.031 inch (.7-.8mm)
- Gasoline Capacity** . . 1.7 U.S. Gallons (6.5l)
- Oil** SAE 10W30

In the State of California a spark arrestor is required by law (Section 4442 of the California Public Resources Code). Other states may have similar laws. Federal laws apply on federal lands.

NOTE: If you equip the muffler with a spark arrestor, it must be maintained in effective working order.

You can order a spark arrestor through your authorized Honda service dealer.



KNOW YOUR PRESSURE WASHER

Read this owner's manual and safety rules before operating your high pressure washer.

Compare the illustrations with your high pressure washer to familiarize yourself with the location of the controls. Save this manual for future reference.

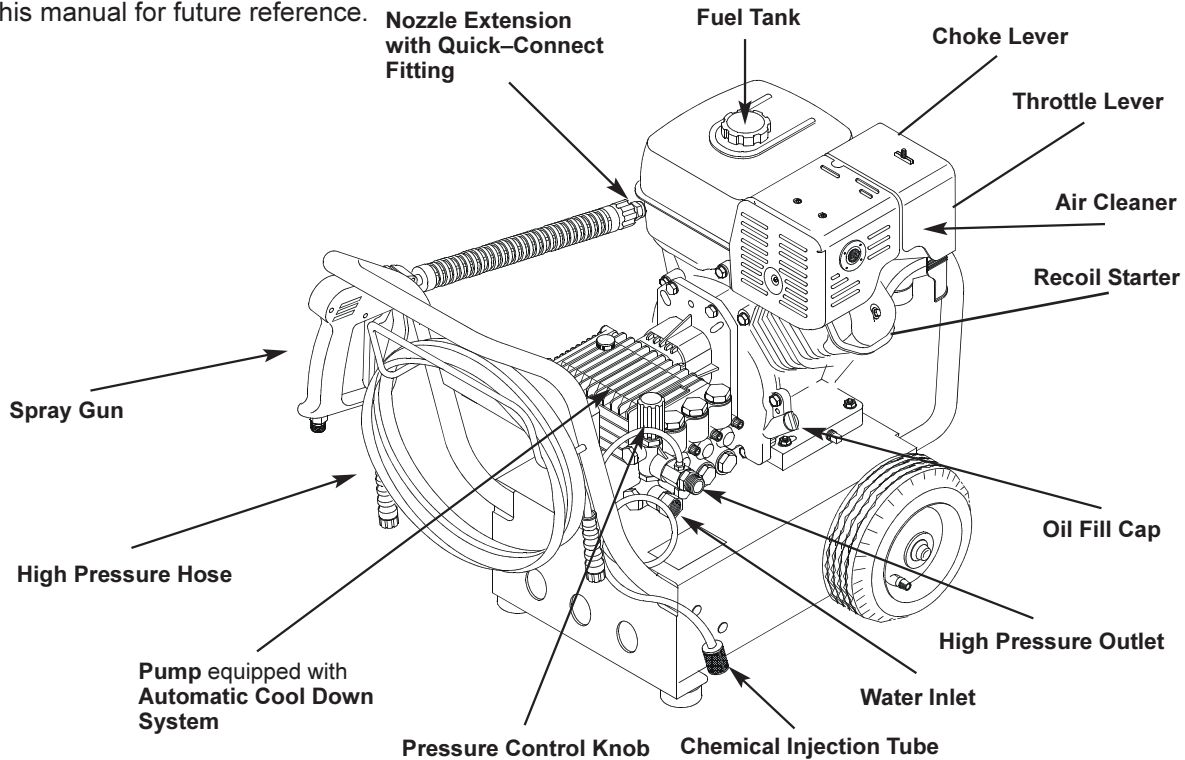

Air Cleaner — Dry type filter element limits the amount of dirt and dust that gets in the engine.

Automatic Cool Down System — Cycles water through pump when water reaches 140°-145°F. **Warm water will discharge from pump onto ground.** This system prevents internal pump damage.

Chemical Injection Tube—Used to siphon chemical from the detergent container to the pump.

Chemical Nozzle — (Not Shown) Use this nozzle to apply chemical.

Choke Lever — Prepares a cold engine for starting.

Fuel Tank — Fill engine with regular unleaded gasoline here.

High Pressure Hose — Connect one end to water pump and the other end to spray gun. Store hose on hook on the rear of the unit

High Pressure Nozzles (not shown)— Use these nozzles to clean and scour a surface. These nozzles vary the spray pattern of the high pressure stream and cannot be used to apply chemical.

High Pressure Outlet — Connection for high pressure hose.

Nozzle Extension with Quick-Connect Fitting — You must attach this to the spray gun to use the nozzles. The quick-connect fitting lets you quickly exchange the five provided nozzles to adjust the spray pattern of the high pressure spray and apply chemical.

Oil Fill Cap —Fill engine with oil here. See page 8 for oil requirements.

Pressure Control Knob — Varies the pressure of the high pressure spray.

Pump — Develops high pressure.

Recoil Starter — Used for starting the engine manually.

Spray Gun — Controls the application of water onto cleaning surface with trigger. Includes safety latch.

Throttle Lever—Sets engine in starting mode for recoil starter and stops a running engine.

Water Inlet — Connection for garden hose.

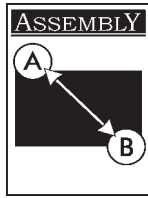

WARNING! Read entire owner's manual before you attempt to assemble or operate your new pressure washer.

REMOVE PRESSURE WASHER FROM CARTON

- Remove the handle and parts box included with pressure washer.
- Slice two corners at the end of carton from top to bottom so the panel can be folded down flat, then remove all packing material.
- Roll pressure washer out of carton.

CARTON CONTENTS

Items in the carton include:

- Main Unit
- High Pressure Hose
- Handle
- Parts Bag (hanging on pump) (includes the following):
 - Oil Dipstick for pump.
- Parts Box (includes the following):
 - (2) 20oz Oil Bottles
 - Goggles
 - Nozzle Cleaning Kit
 - Bag Containing 5 Multi-Colored Nozzles
 - O-Ring Maintenance Kit
 - Owner's Manual
 - Engine Manual

- Engine Warranty
- Emissions Control Warranty
- Spray Gun
- Nozzle Extension with Quick-Connect Fitting.
- Parts Bag (containing hardware to attach handle to pressure washer)
 - 4 Carriage Bolts
 - 4 Flange Nuts

If any of the above parts are missing or damaged, call the pressure washer helpline at **1-800-270-1408**.

PREPARING PRESSURE WASHER FOR USE

If you have any problems with the assembly of your pressure washer or if parts are missing or damaged, call the Pressure Washer Helpline at **1-800-270-1408**.

To prepare your pressure washer for operation you will need to perform these tasks:

- Remove shipping cap from the pump and install oil dipstick.
- Attach the handle to the main unit.
- Add oil to the engine.
- Add fuel to the fuel tank.
- Connect the high pressure hose to the spray gun and the pump.
- Connect the water supply to the pump.
- Connect nozzle extension to gun.
- Select and Install desired nozzle.

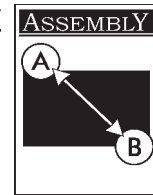

Attach Handle to the Pressure Washer

Use either a 13mm wrench or adjustable wrench to attach the handle to the pressure washer.

To attach handle to the pressure washer (Figure 1):

- Slowly tip the pressure washer forward and let it gently rest on the front bumper.

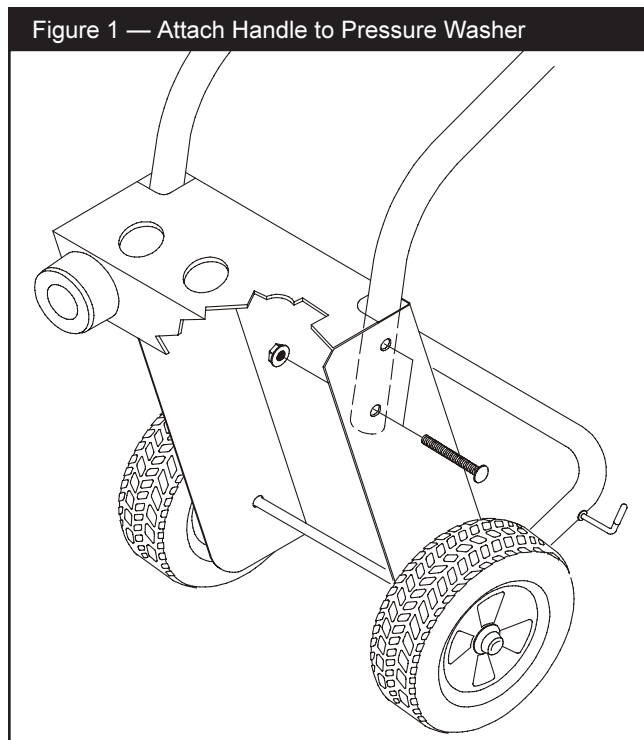

- Align the holes on the handle with the holes on the base.
- Insert the carriage bolts provided to hold the handle in place.
- Secure handle to the pressure washer using the four provided flange nuts.
- Slowly tip the pressure washer back in place and insert the multi-colored nozzles in the spaces provided in the handle.

Install Oil Dipstick on Pump



WARNING! You must remove the shipping cap located on the pump and install the oil dipstick. Failure to do so will void your warranty and damage the pump.

To install the oil dipstick:

- Make sure your unit is on a level surface.
- Remove the shipping cap located on the pump.
- Install the oil dipstick.

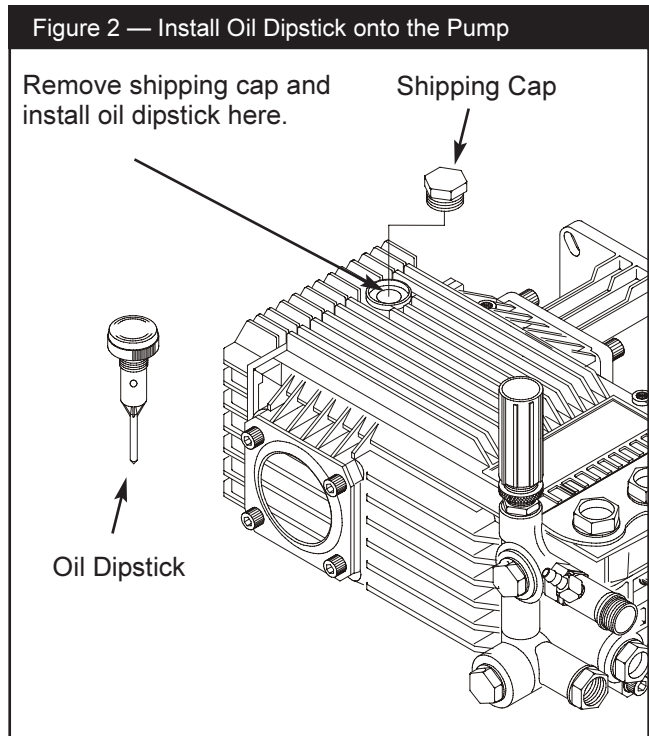

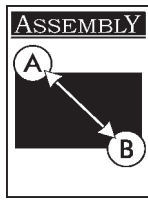

Add Engine Oil



WARNING! Any attempt to crank or start the engine before it has been properly serviced with the recommended oil will result in an engine failure.

Use only high quality detergent oil rated with API service classification SF or SG rated 10W30. Do not use SAE 10W40 oil. Other viscosities shown in the chart below may be used when the average temperature in your area is within the recommended range.

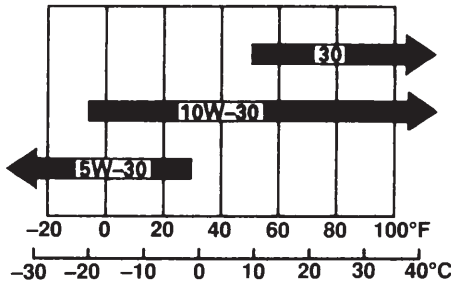

- Place the pressure washer on a level surface.
- Clean the area around oil fill and remove the oil dipstick (Figure 3).

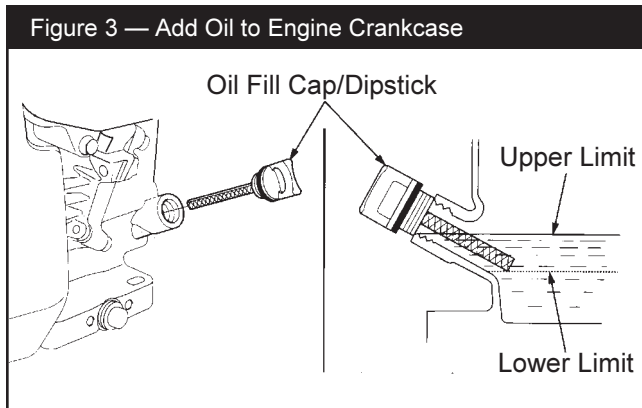

- Wipe the dipstick clean.
- Insert and remove the dipstick without screwing it into the filler neck. Check the oil level shown on the dipstick.

- If the oil level is low, fill to the edge of the oil filler hole with the recommended oil. **DO NOT OVERFILL.**
- Reinstall the oil dipstick, hand tighten securely.

Note: Check Oil Often During Engine Break-in.

Add Gasoline



DANGER! Never fill fuel tank indoors, or when engine is running or hot. **Do not smoke** when filling fuel tank.



WARNING! Never fill fuel tank completely full. Fill tank to about 1/2" below the bottom of the filler neck to provide space for fuel expansion. Wipe away any fuel spillage from engine and equipment before starting.

- Use clean fuel and store in approved, clean covered containers. Use clean fill funnels. Never use "stale" gasoline left over from last season or gasoline stored for long periods.
- Clean the area around the fuel fill cap, remove the cap (Figure 4).

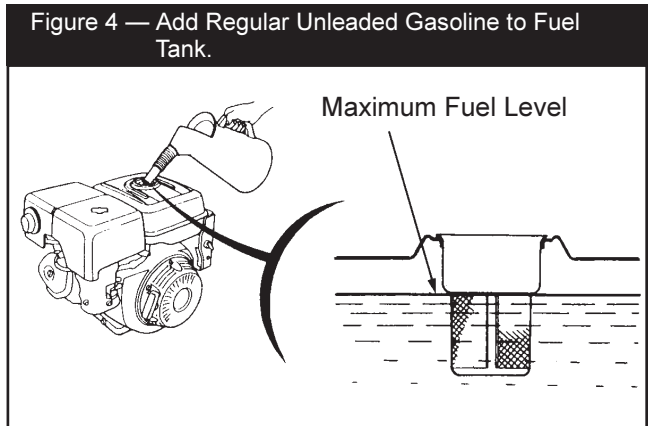

- Add **regular UNLEADED gasoline**, slowly, to fuel tank. Use a funnel to prevent spillage.
- Install the fuel cap and wipe up any spilled gasoline.

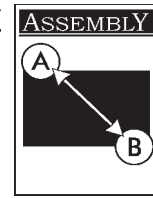

Connect Hose and Water Supply to Pump

IMPORTANT: You must assemble the wand and attach all hoses before you start the engine. Starting engine without all hoses connected and water supplied will damage the pump.

- Uncoil the high pressure hose and attach one end of the hose to the base of the spray gun. (Figure 5). Tighten by hand.

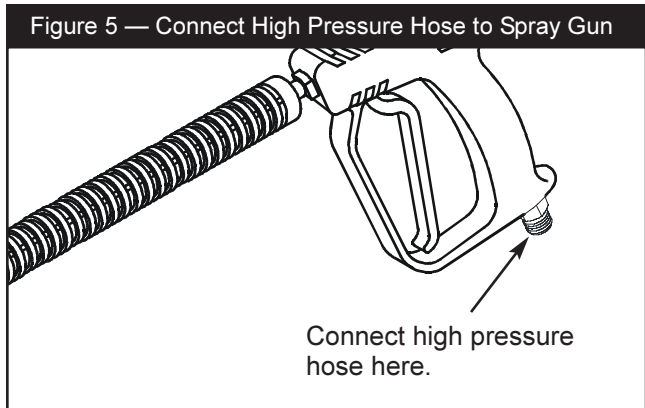

- Attach the other end of the high pressure hose to the high pressure outlet on the pump (Figure 6). Tighten by hand.

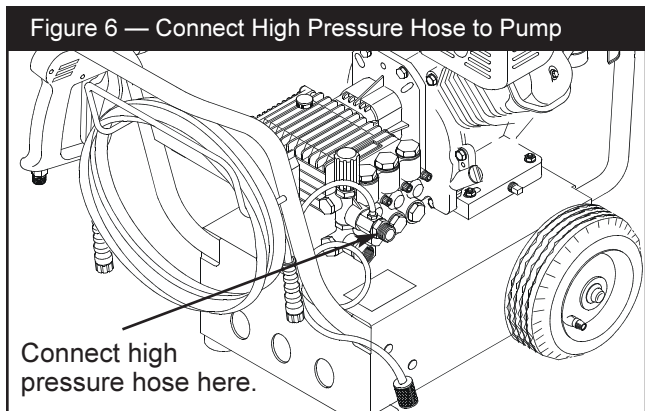

- Before you connect your garden hose to the water inlet, inspect the Inlet Screen (Figure 7). Clean the screen if it contains debris or have it replaced if damaged. **DO NOT RUN THE PRESSURE WASHER IF THE SCREEN IS DAMAGED.**

Figure 7 — Connect the Garden Hose to Water Inlet and Turn ON the Water.

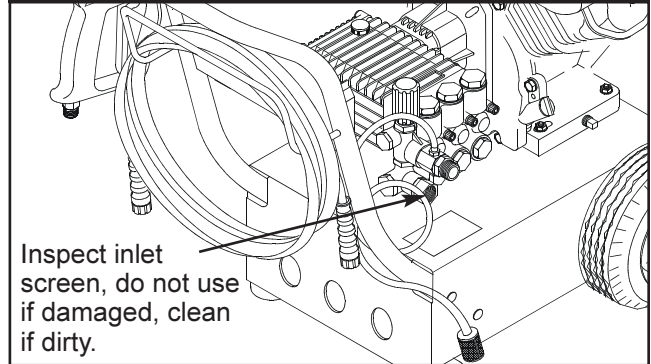

- Run water through your garden hose for 30 seconds to clean out any debris .
- Connect the garden hose to the water inlet. Tighten by hand (Figure 7).
- Turn ON the water.
- Squeeze the trigger on the gun until you have a steady stream of water to purge the pump system of air and impurities.

CAUTION: Before starting the pressure washer, be sure you are wearing adequate eye protection.

- Attach the nozzle extension to the spray gun. Tighten by hand (Figure 8).

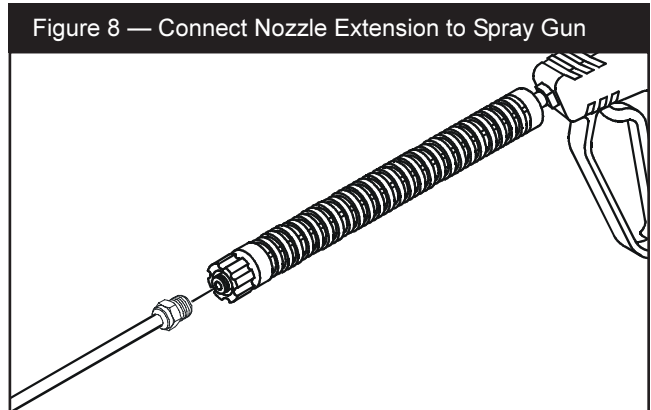



CHECKLIST BEFORE STARTING ENGINE

If you have reached this point, look back over the assembly to see if you have performed all of the following.

- Removed shipping cap from pump and installed dipstick.
- Check for properly tightened hose connections (high pressure and water supply). Also, check to make sure that there are no kinks, cuts, or damage to the high pressure hose.
- Check that oil has been added to the proper level in the engine crankcase before trying to start the pressure washer.
- Add the proper gasoline to fuel tank.
- Provide a proper water supply (not to exceed 140°F).
- Be sure to read the “Safety Rules” and “Operation” sections before using the pressure washer.

HOW TO USE YOUR PRESSURE WASHER

If you have any problems operating your pressure washer, please call the pressure washer helpline at 1-800-270-1408.

How to Start Your Engine

The best way to start your engine-powered pressure washer for the first time is to follow these instructions step-by-step. This starting information also applies whenever you start the engine after you have let the pressure washer sit idle for at least a day.

- Place the pressure washer in an area close enough to an outside water source that can flow at a rate of 4.4 gallons per minute.
- Make sure the unit is in a level position.
- Check that the high pressure hose is tightly connected to the spray gun and to the pump. See “Preparing Pressure Washer for Use” on page 6.

- Connect the garden hose to the water inlet on the pressure washer pump and turn on the water.

WARNING! Do not run the pump without the water supply connected and turned on. You must follow this caution or the pump will be damaged.

- Squeeze the trigger on the spray gun (make sure the nozzle is in low pressure mode) to relieve the air pressure caused by turning ON the water. Water will spew out of the gun in a thin stream. Hold the trigger until a steady stream of water appears. This will make it easier to pull start the engine. Release the trigger.
- Apply the safety latch to the spray gun trigger
- Move the fuel valve to the “ON” position (Figure 9).

Figure 9 — Fuel Valve

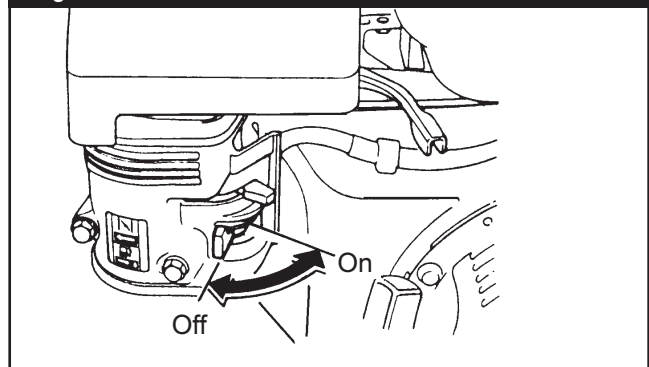

- Move the throttle lever to the “FAST” position (Figure 10).

Figure 10 — Throttle Positions

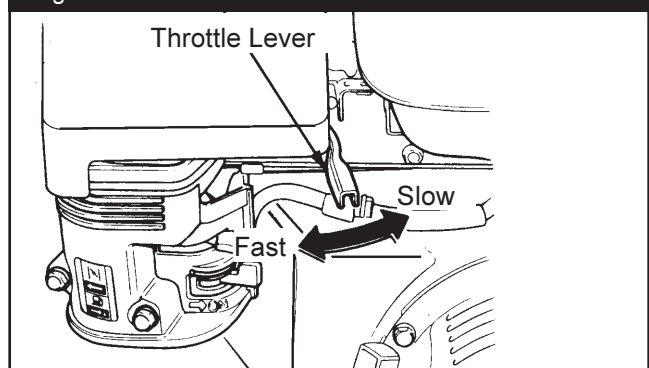



- To start a cold engine, move the choke lever to the “CLOSED” position. To restart a warm engine, leave the choke lever in the “OPEN” position (Figure 11).

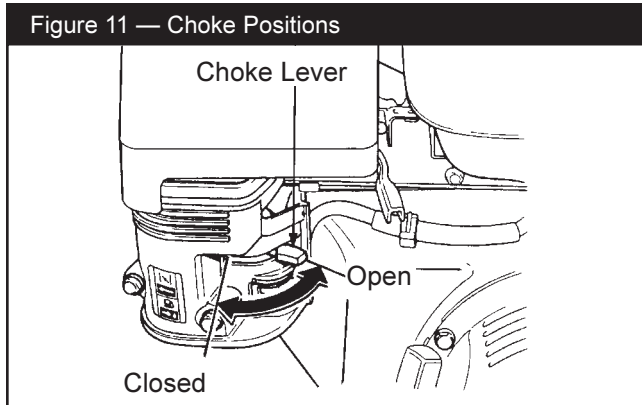

- Set the engine switch to the “ON” position (Figure 12).

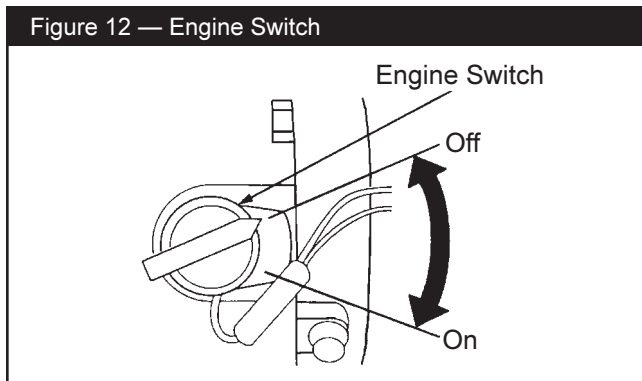

- Grasp starter grip and pull slowly until you feel some resistance. Then pull cord out with rapid full arm stroke. Let rope return slowly. Do not let rope “snap back” against starter.
- If the choke lever has been moved to the “CLOSED” position to start the engine, gradually move it to the “OPEN” position as the engine warms up.

How to Stop Your Pressure Washer

- Move the throttle lever to the “Slow” position.
- Wait for the engine to idle down.
- Move the engine switch to the “OFF” position.
- Simply shutting off the engine will not release pressure in the system. **Squeeze trigger on the spray gun to relieve pressure in the hose.**

Note: A small amount of water will squirt out when you release the pressure.

How to Use the Nozzles

If you have any problems operating your pressure washer, please call the pressure washer helpline at 1-800-270-1408.

! DANGER! Never exchange nozzles without locking the safety latch on the trigger.

The quick-connect on the nozzle extension allows you to switch between five different nozzles. The nozzles vary the spray pattern as shown below (Figure 13).

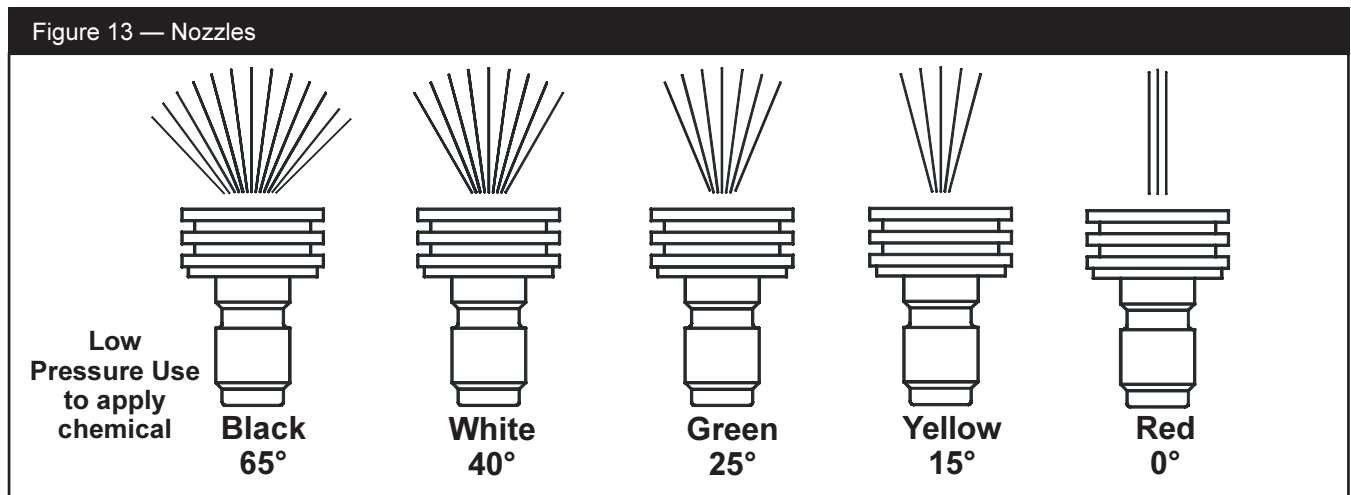



Follow these instructions to change nozzles:

- Engage the safety latch on the spray gun.
- Pull back the collar on the quick-connect and pull the current nozzle off. Store the nozzle in the space provided on the control panel.

Note: For a more gentle rinse, select the white 40° or green 25° nozzle. To scour the surface, select the yellow 15° or red 0° nozzle. To apply chemical, select the black 65° nozzle.

- Pull back on the collar, insert the new nozzle and release the collar. Pull on the nozzle to make sure it is securely in place.
- For most effective cleaning, keep the spray nozzle between 8 to 24 inches away from the cleaning surface. If you get the spray nozzle too close, you may damage the cleaning surface.

Cleaning and Applying Chemical



WARNING! You must **attach all hoses** before you start the engine. Starting the engine without all the hoses connected and without the water turned ON will damage the pump.

IMPORTANT: Use soaps designed specifically for pressure washers. Household detergents could damage the pump.

To apply detergent follow these steps:

- Review the use of the nozzles.
- Prepare the detergent solution as required by the manufacturer.
- Place the small filter of the chemical injection tube into the detergent container.



CAUTION! Keep the chemical injection tube from coming in contact with the hot muffler. This will damage the chemical injection tube. When inserting the filter into a chemical bottle, route the tube so as to keep it from inadvertently contacting the hot muffler.

- Make sure the black nozzle is installed on the nozzle extension.

Note: Detergent cannot be applied with the high pressure nozzles (White, Green, Yellow, or Red).

- Make sure the garden hose is connected to the water inlet. Check that the high pressure hose is connected to the spray gun and the pump and start the engine.
- Apply the detergent to a dry surface, starting at lower portion of area to be washed and work upward, using long, even, overlapping strokes. **Do not allow the detergent to dry on. This will prevent streaking.**
- Allow the detergent to soak in between 3–5 minutes before washing and rinsing. Reapply as needed to prevent surface from drying.

Pressure Washer Rinsing



WARNING! Be extremely careful if you must use the pressure washer from a ladder, scaffolding or any other relatively unstable location. Pressure in a running washer builds as you climb. When you press the trigger, the recoil from the initial spray could force you to fall. The high pressure spray could also force you to fall if you are too close to the cleaning surface.

After you have applied detergent, scour the surface and rinse it clean as follows:

- Apply Safety Latch to Spray Gun.
- Remove the black chemical nozzle from the nozzle extension.
- Select and install the desired high pressure nozzle following the instructions “How to Use the Nozzles” on page 11.
- Keep the spray gun a safe distance from the area you plan to spray.
- Increase or decrease the pressure of the spray by turning the pressure control knob counterclockwise or clockwise respectively (Figure 14). Use lower pressure to wash items such as a car or boat. Use higher pressure to strip paint and degrease driveways.

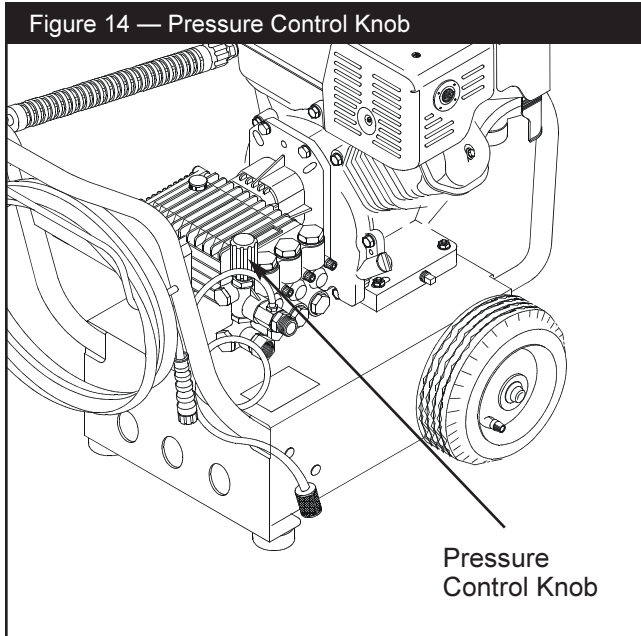
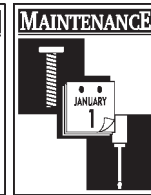

- Apply a high pressure spray to a small area and then check the surface for damage. If no damage is found, you can assume it is okay to continue cleaning.
- Start at the top of the area to be rinsed, working down with same overlapping strokes as you used for cleaning.

Automatic Cool Down System (also known as Thermal Relief)

If you run the engine on your pressure washer for 3–5 minutes without pressing the trigger on the spray gun, circulating water in the pump can reach a temperature between 140–145°F. When the water reaches this temperature, the automatic cool down system engages and cools the pump by **discharging the warm water onto the base and ground**. This system prevents internal damage to the pump.

GENERAL MAINTENANCE RECOMMENDATIONS

The warranty of the high pressure washer does not cover items that have been subjected to operator abuse or negligence. To receive the full value from the warranty, the operator must maintain the high pressure washer as instructed in this manual.

- Some adjustments will need to be made periodically to properly maintain your high pressure washer.
- All adjustments in the Service and Adjustments section of this manual should be made at least once each season.
- Once a year you should clean or replace the spark plug and clean or replace the air filter and check the gun and wand assembly for wear. A new spark plug and clean air filter assure proper fuel–air mixture and help your engine run better and last longer.

Before Each Use

- Check engine oil level.
- Check water inlet screen for damage.
- Check high pressure hose for leaks.
- Check chemical injection tube and filter for damage.
- Check gun and nozzle extension assembly for leaks.
- Rinse out garden hose to flush out debris.

PRESSURE WASHER MAINTENANCE

Check and Clean Inlet Screen

Examine the screen on the water inlet. Clean it if the screen is clogged or replace it if screen is damaged.

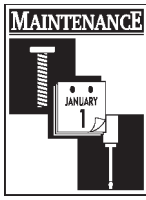

Check High Pressure Hose

The high pressure hose can develop leaks from wear, kinking, or abuse. Inspect the hose each time before using it. Check for cuts, leaks, abrasions or bulging of cover, damage or movement of couplings. If any of these conditions exist, replace the hose immediately.



DANGER! Water spraying from a leak is capable of injecting material into skin. Inspect hose each time before using it. Never repair a high pressure hose. Replace it with another hose that meets the maximum pressure rating of your pressure washer.

Check Gun and Nozzle Extension

Examine the hose connection to the gun and make sure it is secure. Test the trigger by pressing it and making sure it springs back into place when you release it. Put the safety latch in the ON position and test the trigger. You should not be able to press the trigger.

Check In-Line Filter

Refer to Figure 15 and service the in-line filter if it becomes clogged, as follows:

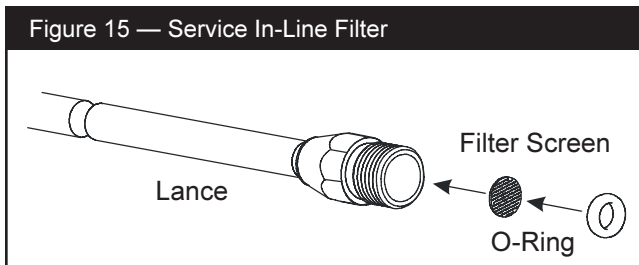

1. Detach gun and lance from high pressure hose. Detach lance from gun and remove o-ring and screen from lance. Flush the screen, gun, and lance with clean water to clear debris.
2. If the screen is damaged, the o-ring kit contains a replacement in-line filter screen and an o-ring. If undamaged, reuse screen.
3. Place the in-line filter screen into the threaded end of the lance. Direction does not matter. Push the screen in with the eraser end of a pencil until it rests flat at the bottom of the opening. Take care to not bend the screen.

4. Place the o-ring into the recess. Push the o-ring snugly against the in-line filter screen.
5. Assemble the lance to the spray gun, as described earlier in this manual.

Check Chemical Injection Tube

Examine the filter on the detergent hose and clean if clogged. The tube should fit tightly on the barbed fitting. Examine the tube for leaks or tears. Replace the filter or tube if either is damaged.

Purge Pump of Air and Contaminants

To remove the air from the pump, follow these steps:

- Set up the pressure washer as described in the “Preparing the Pressure Washer for Use” and connect the water supply.
- Remove the nozzle extension from the gun.
- Pull the trigger on the gun and hold.

To remove the contaminants from the pump, follow these steps:

- Set up the pressure washer as described in the HOW TO USE YOUR PRESSURE WASHER section, and connect the water supply.
- Remove the nozzle extension from the gun.
- Start the engine according to instructions in OPERATION section.
- Squeeze the trigger on the gun and hold.
- When the water supply is steady and constant, engage the safety latch and refasten the nozzle extension.

Cleaning Chemical Injection Tube

If you have used the chemical injection tube you must flush it with clean water before stopping the engine.

- Place the chemical injection tube in a bucket full of clean water.
- Flush for 1–2 minutes.
- Shut off the engine.

Important: Simply shutting OFF engine will not release pressure in the system. When the engine has shut down, squeeze the trigger on the gun to relieve the pressure in the hose.

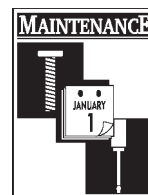

Nozzle Maintenance

If the nozzles becomes restricted or clogged with foreign materials, such as dirt, excessive pump pressure may develop. If the nozzles become partially clogged, it can cause a pulsing sensation during use. This generally is not a pump related problem, but rather a clogged or partially restricted nozzle.

If the nozzles become clogged or partially restricted, immediately clean the nozzles with the kit included with your pressure washer by following these instructions:

- Shut off the engine and turn off the water supply.
- Remove the nozzle from the end of the nozzle extension.
- Use the wire included in the kit or a small paper clip to free the foreign materials clogging or restricting the nozzle (Figure 16).

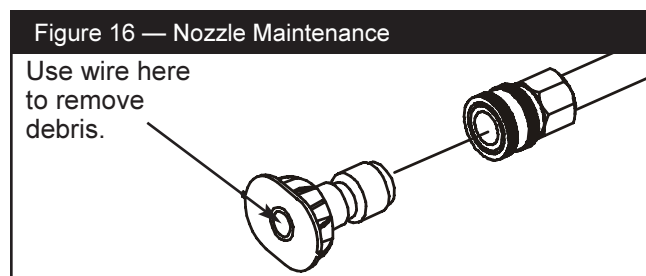

- Remove additional debris by rinsing out the nozzle. Rinse between 30 to 60 seconds.
- Reinstall the nozzle into the nozzle extension.
- Reconnect the water supply, turn on the water, and start the engine.
- Test the pressure washer.

ENGINE MAINTENANCE

See the Engine Owner's Manual for instructions on how to properly maintain the engine.

ENGINE SERVICE

See the engine Owner's Manual for instructions on how to properly service and adjust the engine.

PREPARING UNIT FOR STORAGE

Water should not remain in the unit for long periods of time. Sediments of minerals can deposit on pump parts and "freeze" pump action. If you do not plan to use the pressure washer for more than 30 days, follow this procedure:

1. Flush chemical injection tube by placing the filter into a pail of clean water while running pressure washer with the black chemical nozzle. Flush for one to two minutes.
2. Shut off the engine and let it cool, then remove all hoses.
3. Place the throttle lever in STOP position.

WARNING! Be sure lever is in "STOP" position before you continue. If you start engine without proper water supply connected, you can damage pump.

4. Empty the pump of all pumped liquids by pulling the recoil handle about 6 times. This should remove most of the liquid in the pump.

NOTE: To protect the unit from freezing temperatures, draw RV antifreeze (no alcohol) into the pump by pouring the antifreeze into a 3-foot section of garden hose connected to inlet adapter and pulling recoil handle twice.

5. Store in a clean, dry area.

STORING THE ENGINE

See the Engine Owner's Manual for instructions on how to properly store the engine.



TROUBLESHOOTING

Problem	Cause	Correction
Pump has following problems: Failure to produce pressure, erratic pressure, chattering, loss of pressure, low water volume.	<ol style="list-style-type: none"> Nozzle in low pressure mode. Water inlet is blocked. Inadequate water supply. Inlet hose is kinked or leaking. Clogged inlet hose strainer. Water supply is over 140°F. Outlet hose is blocked or leaks. Gun leaks. Nozzle is obstructed. Pump is faulty. 	<ol style="list-style-type: none"> Pull nozzle backward for high pressure mode. Clear inlet. Provide adequate water flow. Straighten inlet hose, patch leak. Check and clean inlet hose strainer. Provide cooler water supply. Clear blocks in outlet hose. Replace gun. Clean nozzle. Contact Generac service facility.
Detergent fails to mix with spray.	<ol style="list-style-type: none"> Chemical injection tube is not submerged. Chemical filter is clogged. High pressure nozzle attached. 	<ol style="list-style-type: none"> Insert chemical injection tube into detergent. Clean or replace filter/detergent siphoning tube. Use low pressure, black chemical nozzle to apply detergent.
Engine runs good at no-load but "bogs" when load is added.	Engine speed is too slow.	Move throttle control to "FAST" position. If engine still "bogs down" contact Generac service facility.
Engine will not start; or starts and runs rough.	<ol style="list-style-type: none"> Low oil level. Dirty air cleaner. Out of gasoline. Stale gasoline. Spark plug wire not connected to spark plug. Bad spark plug. Water in gasoline. Overchoking. Excessively rich fuel mixture. Intake valve stuck open or closed. Engine has lost compression. 	<ol style="list-style-type: none"> Fill crankcase to proper level. Clean or replace air cleaner. Fill fuel tank. Drain gas tank; fill with fresh fuel. Connect wire to spark plug. Replace spark plug. Drain gas tank; fill with fresh fuel. Open choke fully and crank engine. Contact Honda service facility. Contact Honda service facility. Contact Honda service facility.
Engine shuts down during operation.	<ol style="list-style-type: none"> Out of gasoline. Low oil level. 	<ol style="list-style-type: none"> Fill fuel tank. Fill crankcase to proper level.
Engine lacks power.	Dirty air filter.	Replace air filter.
Engine "hunts" or falters.	Choke is opened too soon.	Move choke to halfway position until engine runs smoothly.

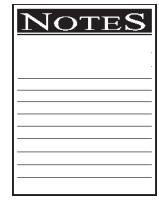

NOTES

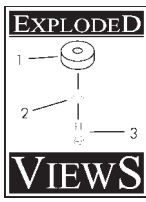

EXPLODED VIEW—MAIN UNIT

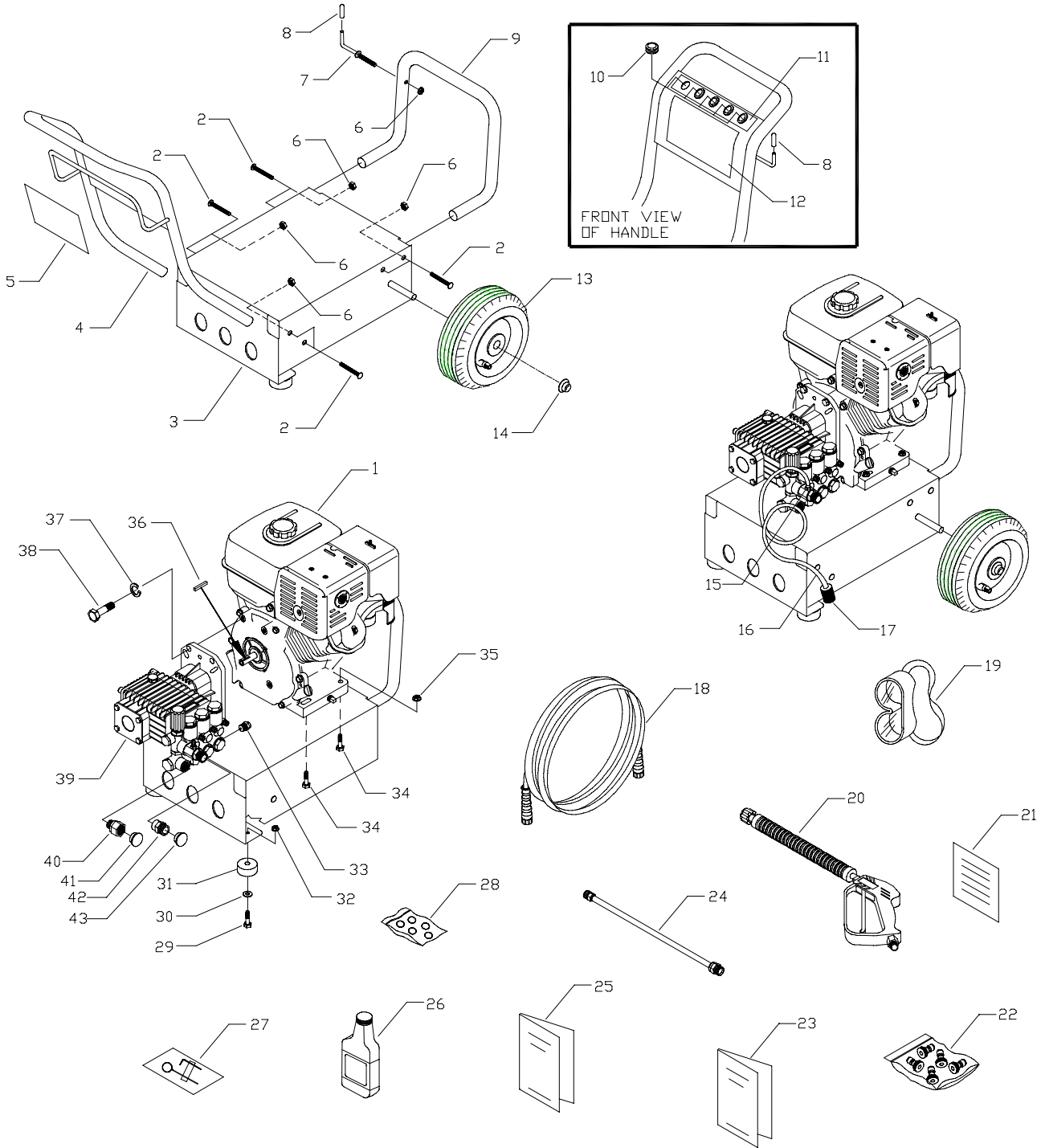

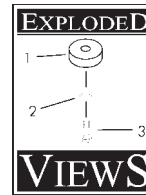

PART LIST—MAIN UNIT

Item	Part #	Qty	Description	Item	Part #	Qty	Description
1	NSP	1	ENGINE, Honda 11HP	22	B4155	1	KIT, Nozzles QD
2	B2043	8	BOLT, 5/16" - 18 x 1-3/4" Carriage	23	B3862	1	MANUAL, Owners
3	BB2226B	1	BASE	24	B3858	1	ASSY, Wand Ext. with QD
4	CB3861A	1	HANDLE	25	B1464	1	MANUAL, Honda
5	B4160	1	DECAL, Instructions	26	NSP	2	BOTTLE, Oil
6	99583	9	NUT, 5/16" - 18 Hex Flange	27	B2163	1	KIT, Nozzle Cleaning
7	B2150	1	HOOK, 5/16" Square Neck Gun	28	B4175	1	KIT, O-Ring Maintenance
8	B2516	2	CAP, Black Vinyl .280"	29	42909	2	HHCS, M8 - 1.25 x 30
9	CB4105	1	BUMPER	30	50190	2	FLAT WASHER, 10GA
10	30809	5	GROMMET, 1/8" - 11/16"	31	27007	2	VIB MOUNT, Donut Type
11	B4159	1	DECAL, 5 QD Nozzles	32	67989	2	NUT, Locking M8 - 1.25
12	B4158	1	DECAL, Unit	33	B1554	1	VALVE, Thermal Relief
13	88521	2	ASSEMBLY, Wheel 10" Dia.	34	64416	4	BOLT, M10 - 1.5 x 45 mm Lg.
14	75402	2	PUSHNUT, .50"	35	52859	4	NUT, Locking M10 - 1.50
15	48031G	1	CLAMP, Hose 7/16" Dia.	36	63281	1	KEY, 1/4" sq. x 2" Lg.
16	A1040D	1	HOSE, 54" Chemical Inject	37	22237	4	LOCKWASHER, 3/8"
17	A1041	1	FILTER, Chemical Hose	38	23645	4	SHCS, 3/8" - 1 1/4"
18	B3636	1	HOSE, 3/8" x 50'	39	B1843	1	PUMP, 3200PSI @ 4GPM
19	87815	1	GOGGLES, Safety	40	95320	1	CONNECTOR, Garden Hose
20	B1436A	1	GUN, with Molded Grip	41	97098	1	CAP, Garden Hose Inlet
21	88681	1	CARD, Owners Registration	42	95457	1	ADAPTER
				43	97100	1	CAP, High Pressure Adapter

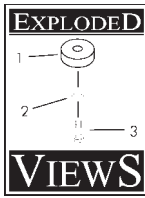

EXPLODED VIEW-PUMP

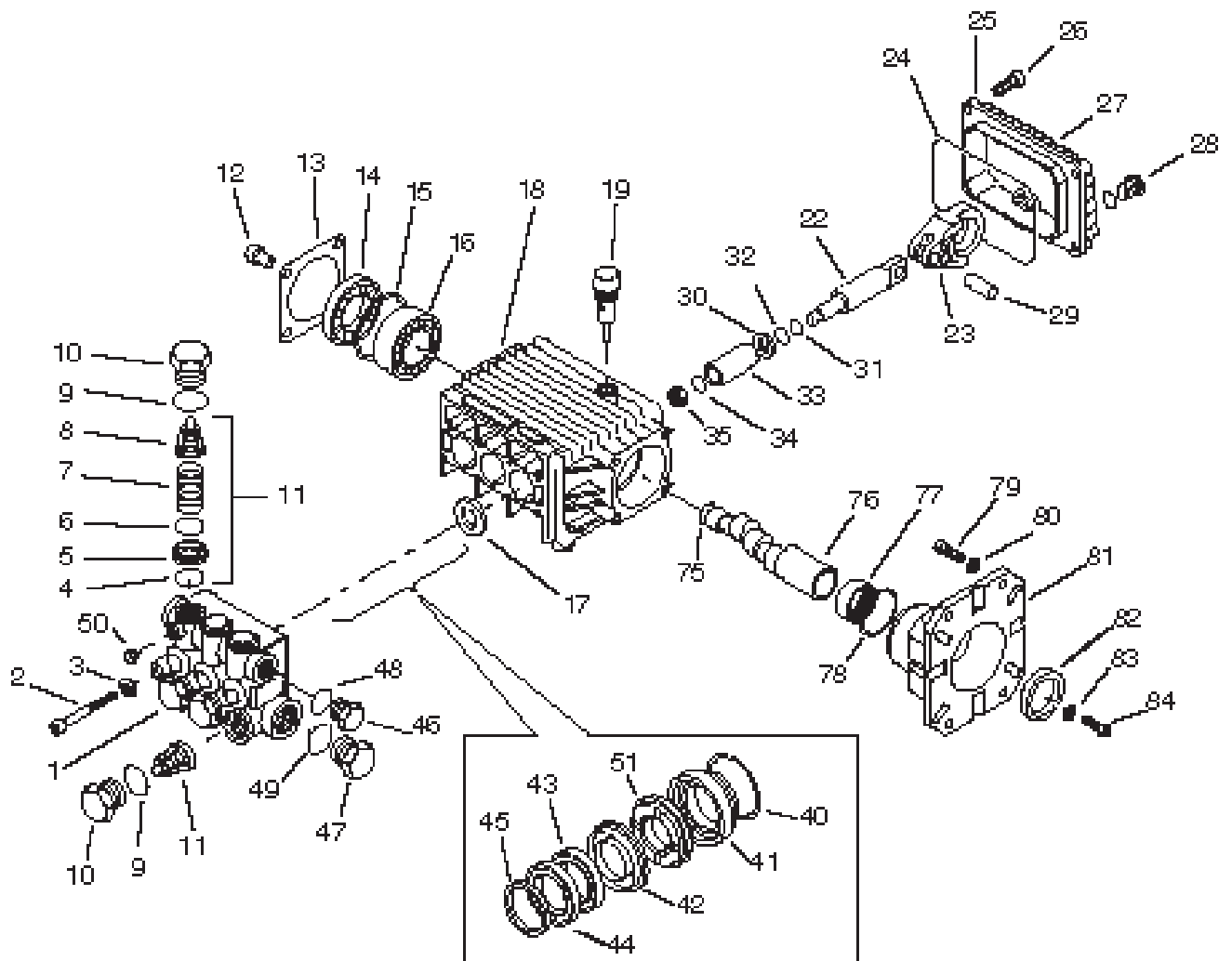

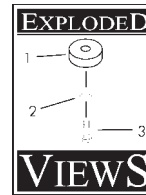

PART LIST-PUMP

Item	Part #	Qty	Description	Item	Part #	Qty	Description
1	100-92294P	1	Pumphead	31	115-92293P	3	Anti Ext. Ring
2	101-92294P	8	Screw	32	114-92293P	3	O-Ring
3	124-92293P	8	Washer	33	115-92294P	3	Piston
4	108-B3169	6	O-Ring	34	113-92293P	3	Washer
5	109-B3169	6	Valve Seat	35	112-92293P	3	Nut
6	110-B3169	6	Valve	40	133-B1843	3	O-Ring
7	111-B3169	6	Spring	41	134-B1843	3	Packing Retainer
8	112-B3169	6	Valve Cage	42	135-B1843	3	Intermediate Ring
9	108-92293P	6	O-Ring	43	136-B1843	3	Packing
10	109-B1843	6	Cap Screw	44	117-B3169	3	Packing
11	115-B3169	6	Valve Assy.	45	116-B3169	3	Head Ring
12	102-92294P	4	Screw	46	101-92293P	1	Cap Screw
13	103-92294P	1	Bearing Cover	47	116-92294P	1	Cap Screw
14	104-92294P	1	Spacer	48	134-92294P	1	Washer
15	129-92293P	1	O-Ring	49	118-92294P	1	Washer
16	105-92294P	1	Ball Bearing	50	119-92294P	1	Cap Screw
17	116-B1843	3	Oil Seal	51	144-B1843	3	Seal, Low Press
18	106-92294P	1	Crankcase	75	120-92294P	1	Retaining Ring
19	94504	1	Oil Dip Stick	76	121-92294P	1	Crankshaft
22	107-92294P	3	Piston Guide	77	122-92294P	1	Roller Bearing
23	108-92294P	3	Connecting Rod	78	129-92293P	1	O-Ring
24	109-92294P	1	O-Ring	79	149-B1843	4	Screw 5/16 x 1
25	110-92294P	1	Rear Cover	80	150-B1843	4	Washer 8mm
26	111-92294P	5	Screw	81	123-92294P	4	Gas Flange
27	112-92294P	1	O-Ring	82	124-92294P	1	Oil Seal
28	104-92293P	1	Cap Screw	83	106-92293P	4	Washer
29	113-92294P	3	Pin	84	126-92294P	4	Screw
30	114-92294P	3	Washer				

Kit No.	503-92294P	201-B1843	202-B1843	203-B1843	500-92294P	501-92294P	206-B1843	504-92294P
Item #'s Included with kit	17	43,44,51	42	45	4, 5, 6, 7, 8, (11)	9, 10	40, 41	40, 41, 42, 43, 44, 45, 51
Number of Assemblies in Kit	3	3/6	3	6	6	6	3	1
Number of Cylinders Kit will Service	3	3	3	3	3	3	3	1

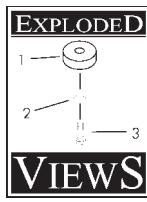

EXPLODED VIEW-UNLOADER

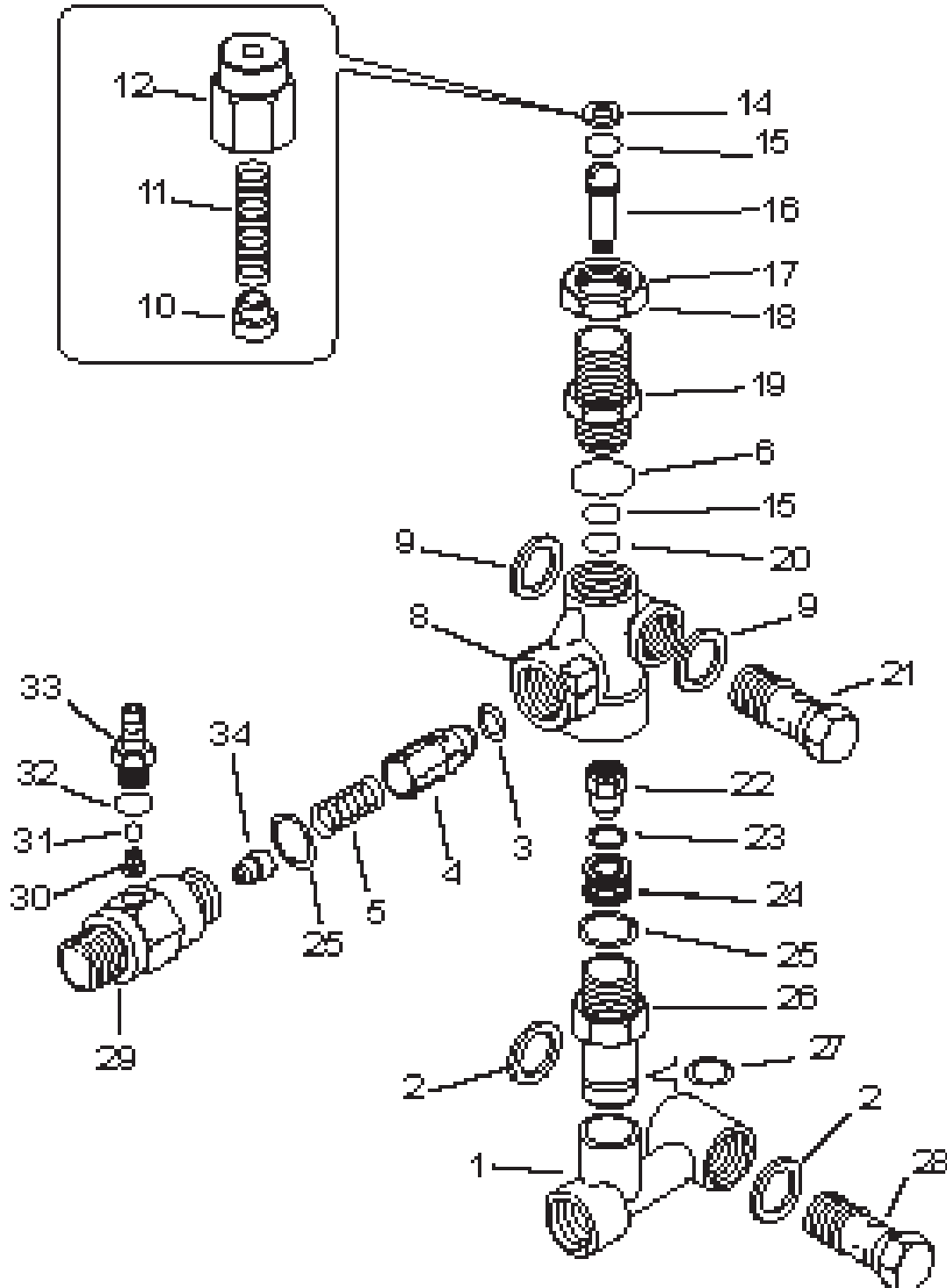

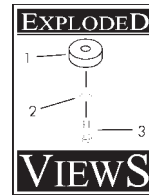

PARTS LIST-UNLOADER

Item	Part #	Qty	Description	Item	Part #	Qty	Description
1	155-B1843	1	Manifold	20	172-B1843	1	Backup Ring
2	156-B1843	2	Seal Washer	21	173-B1843	1	Banjo Bolt
3	157-B1843	1	O-Ring	22	174-B1843	1	Valve
4	158-B1843	1	Check Valve, Hexa.	23	175-B1843	1	O-Ring
5	159-B1843	1	Spring	24	176-B1843	1	Seat
6	160-B1843	1	O-Ring	25	177-B1843	2	O-Ring
8	161-B1843	1	Valve Body Brass	26	178-B1843	1	Bypass Fitting
9	162-B1843	2	Seal Washer	27	179-B1843	1	O-Ring
10	163-B1843	1	Spring Support	28	180-B1843	1	Banjo Bolt
11	164-B1843	1	Spring White	29	181-B1843	1	Injector Body
12	165-B1843	1	Cap Brass	30	182-B1843	1	Spring Conical
14	166-B1843	1	Back up Ring	31	183-B1843	1	Ball
15	167-B1843	1	O-Ring	32	184-B1843	1	O-Ring
16	168-B1843	1	Piston, SS	33	185-B1843	1	Hose Barb
17	169-B1843	1	Nut, Ring	34	186-B1843	1	Injector Nozzle
18	170-B1843	1	Screw Set	35	187-B1843	0	Unloader Complete
19	171-B1843	1	Piston Housing				

LIMITED PRESSURE WASHER WARRANTIES

(INCLUDES “MASTER CONTRACTOR”)

GENERAC PORTABLE PRODUCTS (hereafter referred to as the COMPANY) warrants to the original retail purchaser, the pressure washer manufactured by the COMPANY to be free from defects in material and workmanship for the period(s) set forth below from the date of original purchase. This warranty is not transferable. The term “original purchaser” means the person for whom the pressure washer is originally purchased.

Warranty Schedules

Electric Power Washer	1 year (does not apply to commercial or rental applications)		
	CONSUMER*	COMMERCIAL*	
All Other Engine-driven	Engine:	Warranted solely by Engine Manufacturer	Warranted solely by Engine Manufacturer
	Pump:	1 year	90 days

*** NOTE: For the purpose of this warranty “consumer” use means personal residential household use by original purchaser. “Commercial” use means all other uses, including rental, construction, commercial and income producing purposes. Once a pressure washer has experienced commercial use, it shall thereafter be considered a commercial use pressure washer for the purposes of this warranty.**

During said warranty period, the COMPANY will, at its option, repair or replace any part which, upon examination by the COMPANY or COMPANY-Authorized Dealers, is found to be defective under normal use and service**. All transportation costs under warranty, including return to the factory if necessary, are to be borne by the purchaser and prepaid by the purchaser.

**** NORMAL WEAR: As with all mechanical devices, pressure washers need periodic parts service and replacement to perform well. This warranty does not cover repair when normal use has exhausted the life of a part or pressure washer pump.**

This warranty does not include: Used products and demonstration equipment. Parts, such as GUNS, HOSES, WANDS, NOZZLES or other wear items such as quick couplers, oil, gauges, belts, o-rings, filters, pump packing, etc. Pumps which have been run without water supplied. Damage or malfunctions resulting from: accidents, abuse, modifications, alterations, or improper servicing. Freezing or chemical deterioration. Normal maintenance such as adjustments, fuel system cleaning and obstruction (due to chemical, dirt, carbon or lime, etc.).

THIS WARRANTY IS IN PLACE OF ALL OTHER WARRANTIES, EXPRESS OR IMPLIED, SPECIFICALLY, THE COMPANY MAKES NO OTHER WARRANTIES AS TO MERCHANTABILITY OR FITNESS FOR A PARTICULAR PURPOSE. THE DURATION OF ANY IMPLIED WARRANTIES WHICH CANNOT BE DISCLAIMED IS LIMITED TO THE TIME PERIOD AS SPECIFIED IN THE EXPRESS WARRANTY. LIABILITY FOR CONSEQUENTIAL, INCIDENTAL, OR SPECIAL DAMAGES UNDER ANY AND ALL WARRANTIES IS EXCLUDED, EVEN IF SUCH DAMAGES ARE A DIRECT RESULT OF THE COMPANY'S NEGLIGENCE. THE COMPANY ALSO DISCLAIMS ANY RESPONSIBILITY FOR INCIDENTAL OR CONSEQUENTIAL DAMAGES SUCH AS THE LOSS OF TIME OR THE USE OF THE POWER EQUIPMENT, OR ANY COMMERCIAL LOSS DUE TO THE FAILURE OF THE EQUIPMENT: AND ANY IMPLIED WARRANTIES ARE LIMITED TO THE DURATION OF THIS WRITTEN WARRANTY.

Some states do not allow limitations on how long an implied warranty lasts, or the exclusion or limitation of incidental or consequential damages, so the above limitations or exclusions may not apply to you. This warranty gives you specific legal rights and you may also have other rights, which vary from state to state.

For service, see your nearest COMPANY-Authorized warranty service facility or call 1-877-544-0982. Warranty service can be performed only by a COMPANY-Authorized service facility. This warranty will not apply to service at any other facility. At the time of requesting warranty service, evidence of original purchase date must be presented.

Generac Portable Products

Jefferson, Wisconsin U.S. A.