

1902-1 - 2,350 PSI Troy-Bilt - Pump

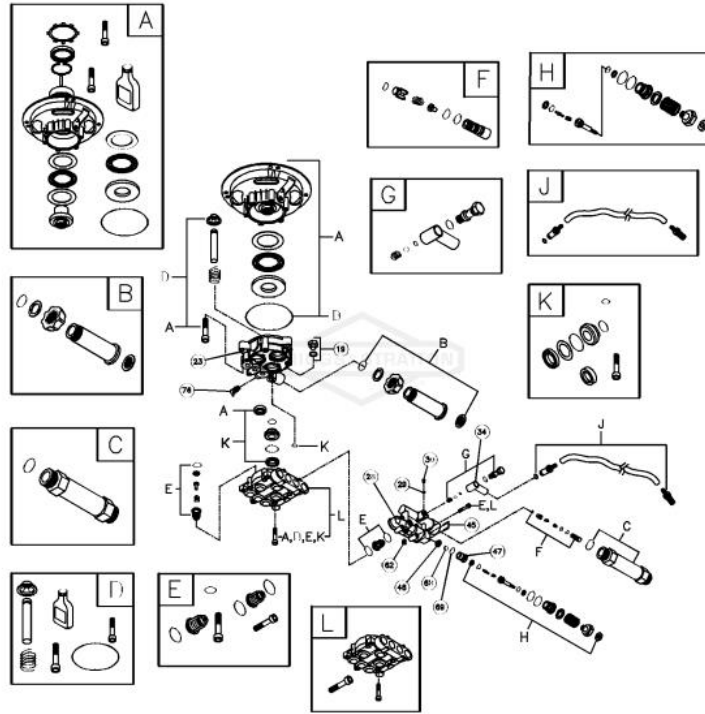

Ref #	Part #	Description	Qty	Context Note	Foot Note
19	190571GS	CAP, Oil			
23	193817GS	HOUSING, Piston			
28	190627GS	MANIFOLD			
29	190575GS	O-RING			
30	190576GS	SCREW			
34	190577GS	CONNECTION, Chemical Inlet			
45	190578GS	PIN			
46	190579GS	VALVE, Seat Plate, Brass			
47	190580GS	VALVE, Seat, Stainless			
62	190581GS	CAP			
68	190582GS	BALL, SS			
69	190584GS	O-RING			
76	21783GS	THERMO RELIEF			
77	190586GS	OIL BOTTLE			
A	193804GS	KIT,WOBBLE PLATE BEARING		Service kit includes all parts shown within the box.	
B	190632GS	KIT,WATER INLET,ALUM		Service kit includes all parts shown within the box.	
C	190634GS	KIT, OUTLET,ALUM		Service kit includes all parts shown within the box.	
D	193805GS	KIT, PISTON		Service kit includes all parts shown within the box.	
E	193806GS	KIT,CHECK VALVES		Service kit includes all parts shown within the box.	
F	190592GS	KIT, INLET CHECK		Service kit includes all parts shown within the box.	
G	190593GS	KIT, CHEMICAL INJECTION		Service kit includes all parts shown within the box.	
H	190594GS	KIT, UNLOADER STEM		Service kit includes all parts shown within the box.	
J	189971GS	KIT, CHEMICAL HOSE		Service kit includes all parts shown within the box.	
K	193807GS	KIT, SEAL SET		Service kit includes all parts shown within the box.	
L	193808GS	KIT, HEAD BRASS		Service kit includes all parts shown within the box.	