

BM80920 SERIES QUICK REFERENCE GUIDE

⚠ WARNING:

This Quick Reference Guide is not a substitute for reading the operator's manual. To reduce the risk of injury or death, user must read and understand operator's manual before using this product. All page references refer to the operator's manual.

FIRST TIME ASSEMBLY

1 Secure the handle (see page 8).

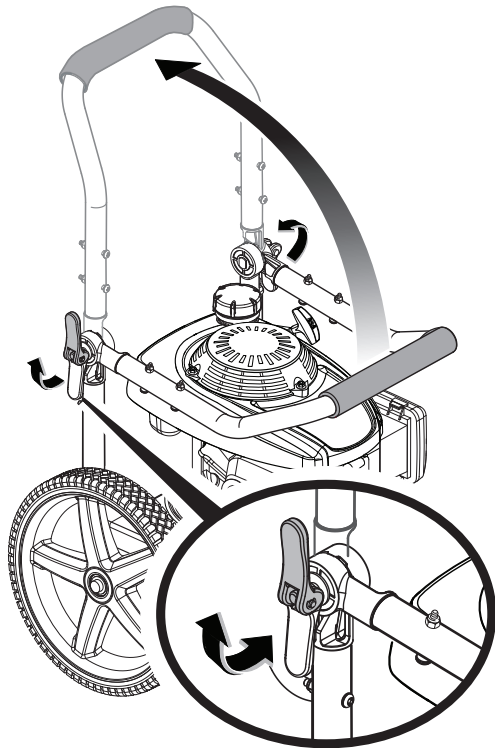

2 Attach the rear panel (see page 8).

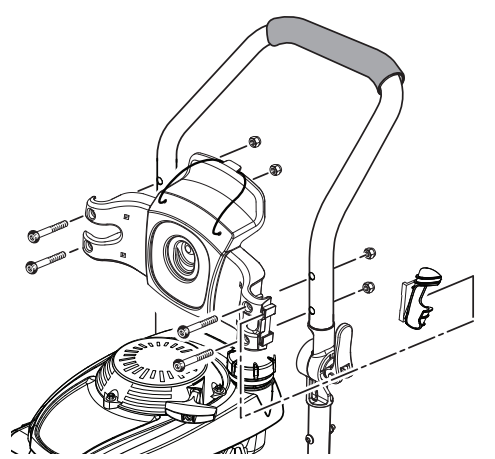

3 Connect the spray wand to the trigger handle (see page 8).

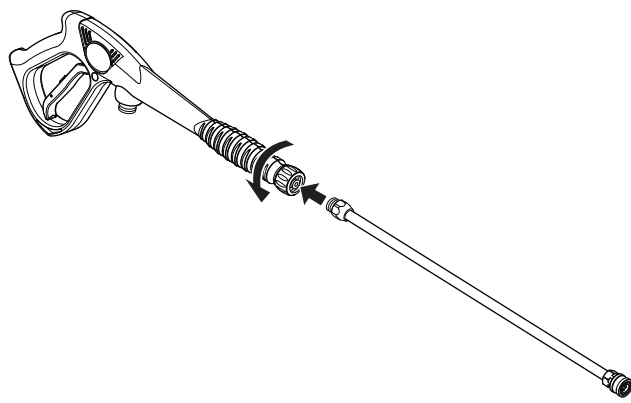

4 Connect the high pressure hose to the trigger handle (see page 9).

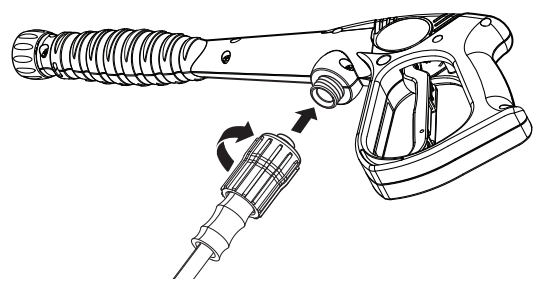

5 Connect the high pressure hose to the pump (see page 9).

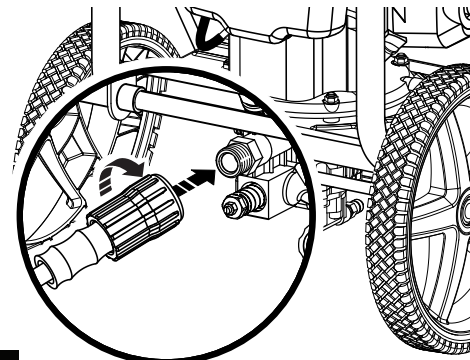

Completely uncoil and straighten high pressure hose to prevent kinks.

6 Connect your garden hose to the pressure washer (see page 9).

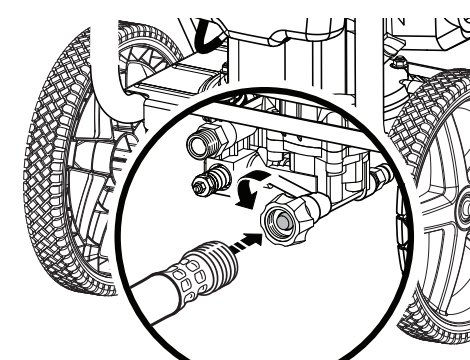

Completely uncoil garden hose or remove completely from reel to prevent kinks.

Turn water faucet on fully.

Make sure there are no leaks.

With no nozzle installed, squeeze the trigger to relieve air pressure. Hold the trigger until a steady stream of water appears.

7 Add entire bottle of lubricant provided to the pressure washer (see page 10).

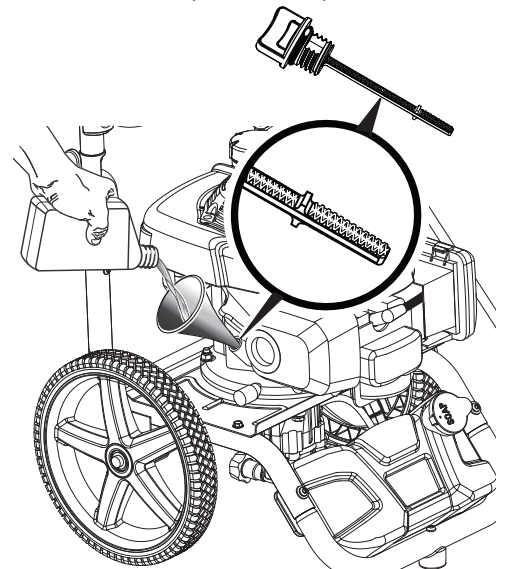

Set unit on flat surface so engine is level. Remove dipstick, wipe clean, put back in hole (but don't screw in) and check lubricant level.

DO NOT OVERTILT THE UNIT!

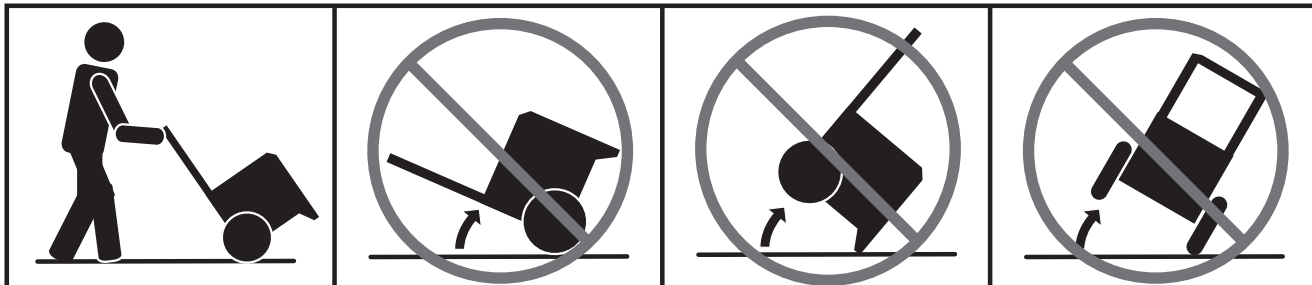

STARTING THE UNIT (COLD START)

1 Add fuel (see page 11).

NOTICE: Do not use E15 or E85 fuel (or fuel containing greater than 10% ethanol) in this product. It is a violation of federal law and will damage the unit and void your warranty.

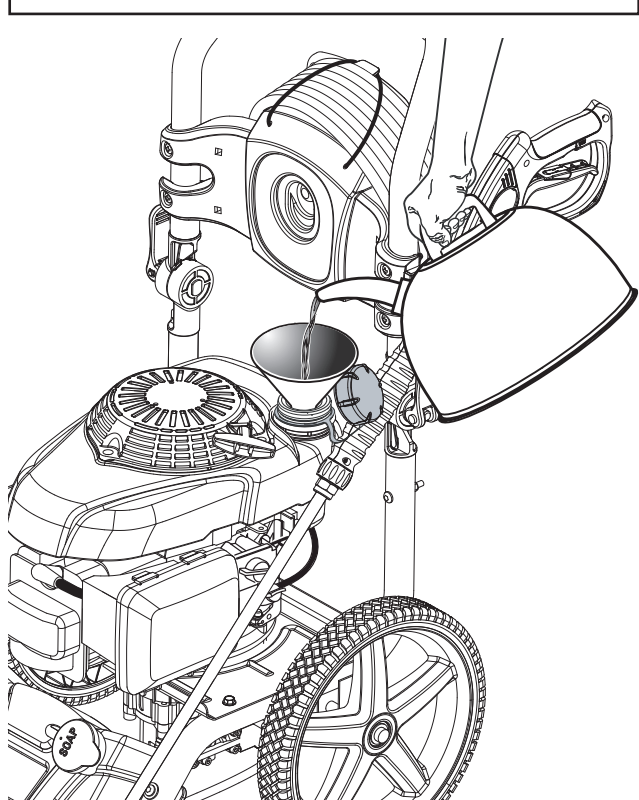

This is a 4-cycle engine. Do not mix fuel and oil together.

Add fuel stabilizer every time you fuel the machine.

2 Turn fuel valve to the ON position (see page 11).

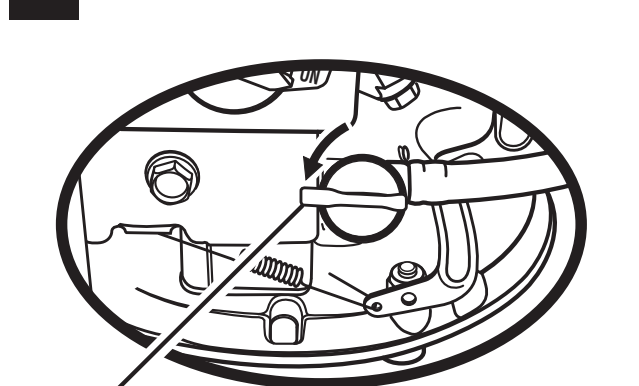

FUEL VALVE OPEN POSITION

3 Put choke in ON position (see page 11).

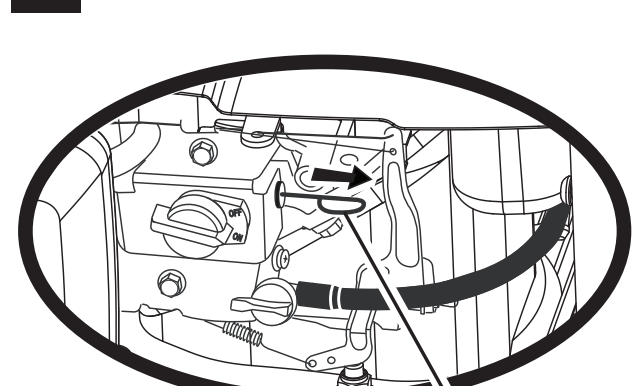

CHOKE IN START POSITION

4 Put engine switch in ON position (see page 11).

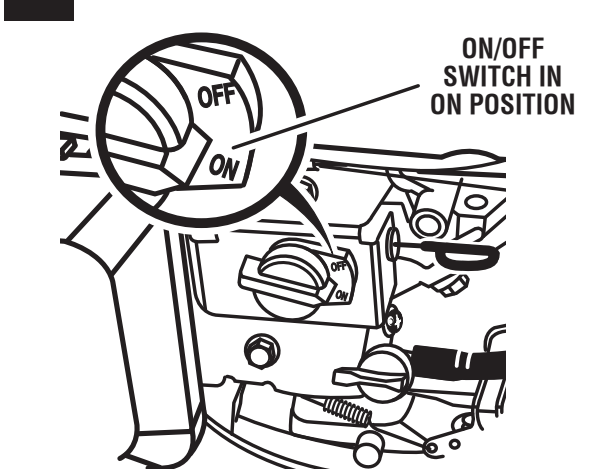

5 Pull starter grip to start (see page 11).

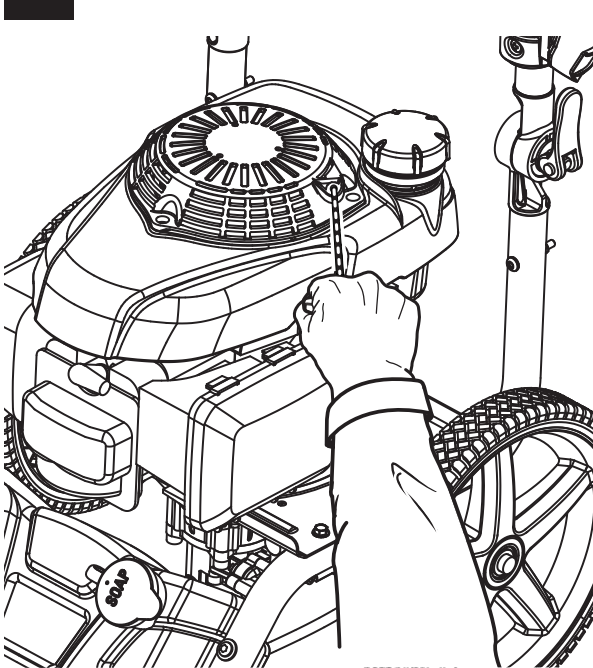

6 Allow engine to run for several seconds, then push choke in (see page 11).

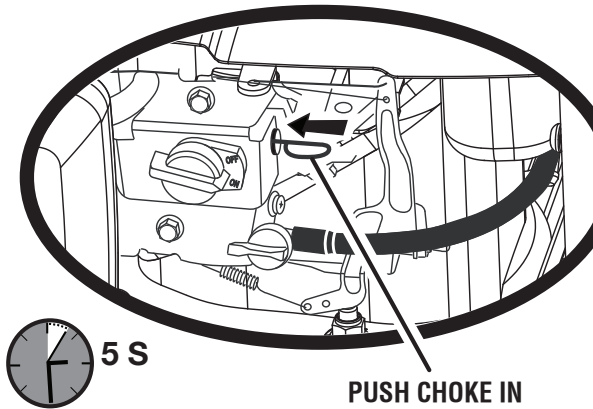

RESTARTING THE UNIT (HOT RESTART)

1 Pull starter grip to start (see page 11).

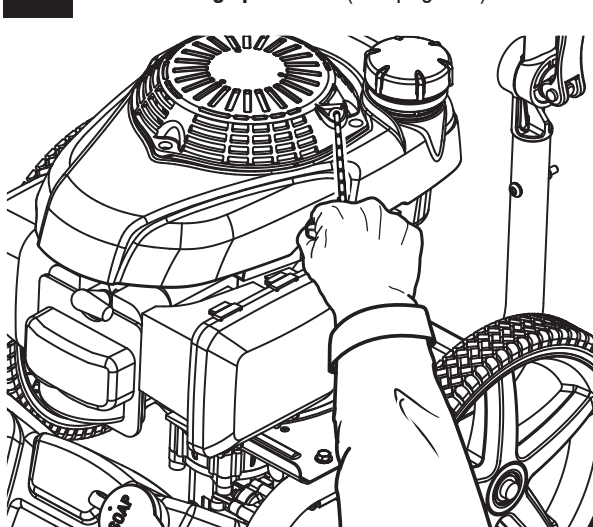

USING DETERGENT

1 Pour pressure washer detergent in detergent tank (see page 13).

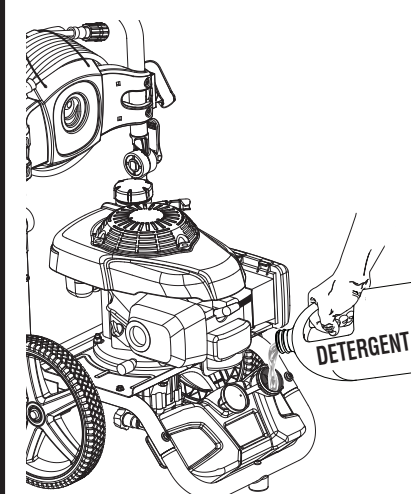

2 Install nozzle and rotate selector to blue or blue setting (see page 12).

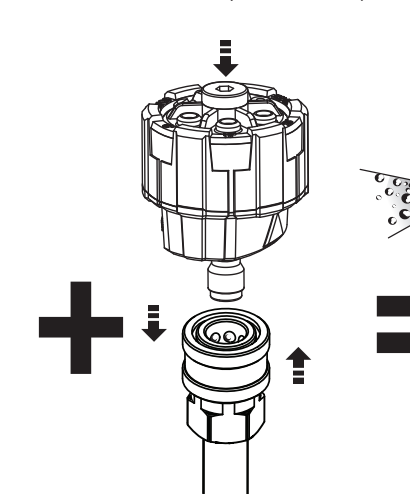

3 Squeeze trigger and wait approx. 5 seconds for soap (see page 13).

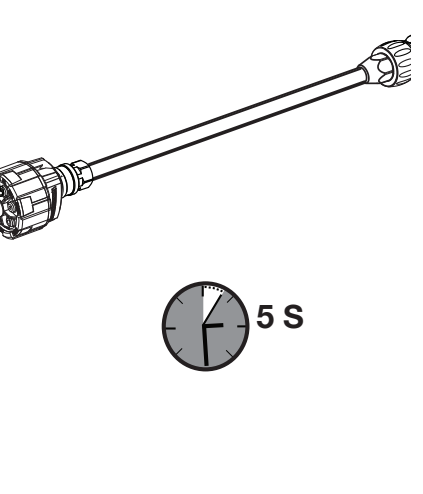

BLEACH

Use of soap nozzle will activate detergent injector at a 20:1 dilution ratio. **WARNING!** Never use bleach or solvent-based detergent.

- Will damage your pump
- Will void your warranty
- Will damage plants/shrubs

NOZZLE SELECTION GUIDE

NOZZLE	HIGH PRESSURE (NO SOAP WHEN USING THESE NOZZLES)					LOW PRESSURE (FOR SOAP OR GENTLE RINSE. NOTE: IF DISPENSING SOAP, YOU MUST USE ONE OF THESE SETTINGS)	
	0°	25°	40°	CAR	SOAP	Long Range	Short Range
ABRASIVE	✓	✓	✓	✓	✓	✓	✓
Concrete, Brick, Masonry	✓	✓	✓	✓	✓	✓	✓
Siding, Gutters, House		✓	✓	✓	✓	✓	✓
Fencing, Deck, Patio		✓	✓	✓	✓	✓	✓
Lawn Equipment, Boat, RV		✓	✓	✓	✓	✓	✓
✓ Recommended Nozzle ✓ Use With Caution for Certain Applications							

BEFORE STORING THE UNIT

1 Add Pump Protector to the unit after each use and before storing. This will significantly improve pump life. To order Pump Protector, call customer service at 1-800-726-5760. To add, follow the instructions provided by the Pump Protector manufacturer. (See page 14.)



If you need more assistance, visit our website at www.blackmaxtools.com or call us at 1-800-726-5760.